

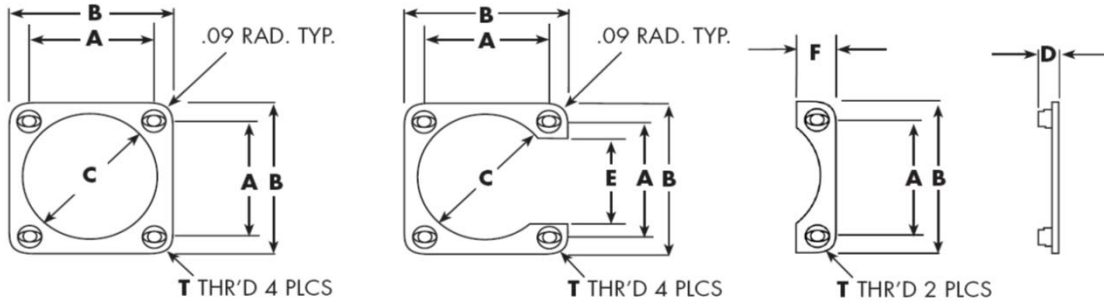

Stroco Manufacturing, Inc.  
 628 Lambert Pointe Drive  
 Hazelwood, MO 63042  
 ph. (800) 489-6050  
 fax (314) 522-8805  
 sales@stroco.com



STROCO P/N	SHELL SIZE	T THR'D UNC-3B	"A" (+/- .003)	"B" (+.015/- .015)	"C" (+.015/- .000)	"D"	"E" (+.020/- .020)	"F" (+.015/- .000)
S915-3	3	.112-40	0.625	0.925	0.641	.106/.166	0.325	0.286
S915-6	6	.112-40	0.469	0.755	0.366	.106/.166	0.183	0.286
S915-8	8	.112-40	0.594	0.880	0.554	.106/.166	0.308	0.286
S915-10	10	.112-40	0.719	1.019	0.688	.106/.166	0.433	0.286
S915-12	12	.112-40	0.812	1.098	0.828	.106/.166	0.526	0.286
S915-14	14	.112-40	0.906	1.192	0.953	.106/.166	0.620	0.286
S915-16	16	.112-40	0.969	1.255	1.094	.106/.166	0.683	0.286
S915-18	18	.112-40	1.062	1.348	1.185	.106/.166	0.776	0.286
S915-20	20	.112-40	1.156	1.500	1.305	.106/.166	0.812	0.344
S915-22	22	.112-40	1.250	1.593	1.428	.106/.166	0.907	0.344
S915-24	24	.138-32	1.375	1.750	1.568	.123/.183	1.000	0.375
S915-25	25	.138-32	1.500	1.812	1.582	.123/.183	1.062	0.375
S915-28	28	.138-32	1.562	2.000	1.820	.123/.183	1.125	0.438
S915-32	32	.138-32	1.750	2.312	2.062	.123/.183	1.188	0.562
S915-36	36	.138-32	1.938	2.500	2.312	.123/.183	1.375	0.562
S915-37	37	.112-40	1.187	1.500	1.281	.106/.166	0.874	0.313
S915-40	40	.164-32	2.188	2.925	2.675	.128/.210	1.500	0.713
S915-61	61	.112-40	1.437	1.812	1.594	.106/.166	1.062	0.375

**SPECIFICATIONS**

**MATERIAL:** Retainer- Aluminum alloy, 6061-T6 per QQ-A-250/11, .032" (+.003/ -.003) thickness  
 Nut- Self-Locking, clinch type, corrosion resistant alloy steel per AMS5640 (type 303)  
 Performance per MIL-N-25027

**FINISH:** Retainer- Alodine per MIL-C-5541 CI 1A  
 Optional- Epoxy Polyamide primer applied per MIL-P-23377  
 Nut- Per MIL-N-45938 with dry film lubricant applied per MIL-L-46010

**NOTES:** The A, B, C, and E dimensions are to be measured in the restrained position.  
 This data sheet represents all options for this series, see ordering info page for part specifics.  
 Parts to be marked with the respective S915-XXX part number, if there is enough space.

DIMENSIONS IN INCHES: TOLERANCES UNLESS OTHERWISE SPECIFIED: X.XX +/- .030"; X.XXX +/- .010"; ANGLES +/- .05\*

DOCUMENT AND ITS CONTENTS ARE PROPRIETARY INFORMATION TO STROCO AND ITS AFFILIATES, USE WITHOUT AUTHORIZATION IS PROHIBITED.

CAGE NO.  19904	TITLE: NUT PLATE    	PART NUMBER  S915
	DRAWING FOR INTERNAL USE ONLY	

